

BY SWEDEN

STRIHL®

HERCULES

220-
240V

50Hz-
60Hz

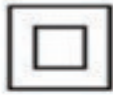

IP66

IK08



CE

EN 14

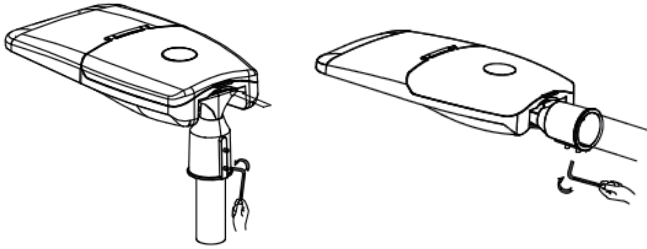

Tighten pole bracket with 10Nm

OPEN

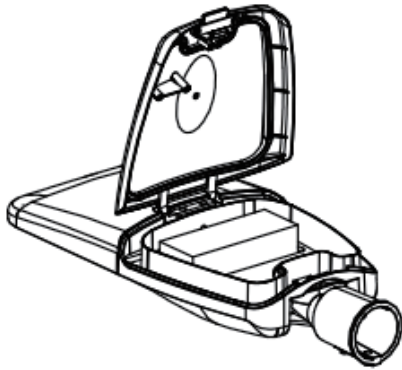
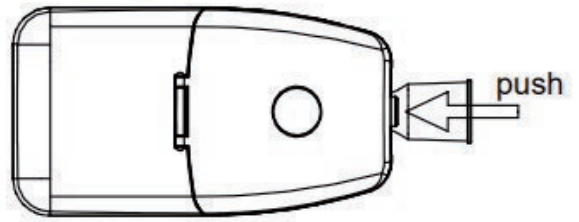

CLOSE

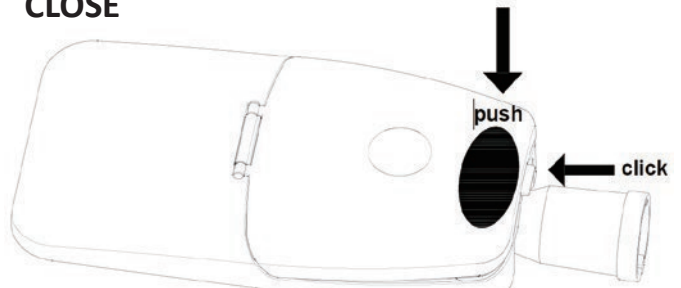

Make sure the luminaire is properly closed

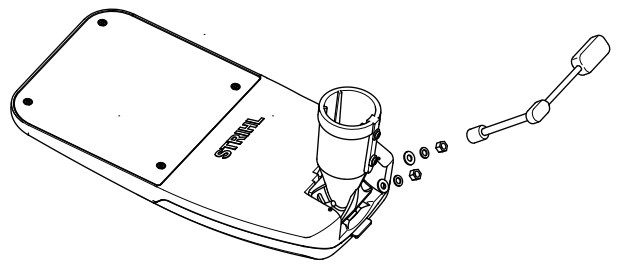
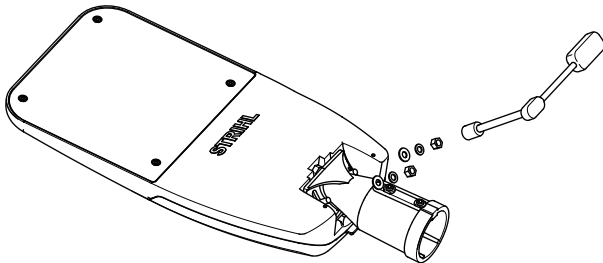
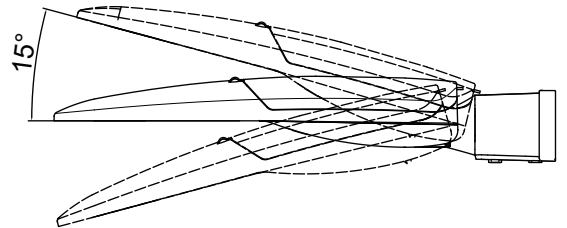
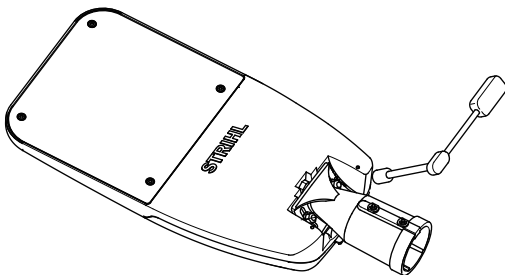

STRIHL Scandinavia AB
Magasinsgatan 6B
434 37 Kungsbacka, Sweden
+46 (0)300-569980
info@Strihl.se



ATTENTION
**RED + Purple +
 White + Gray signal
 cables has to be
 isolated if not used.**

Cable 2-wired

Brown	Line 230Vac
Blue	Neutral 230Vac

Cable 5-wired

Brown	Line 230Vac
Blue	Neutral 230Vac
Green/Yellow	Ground
Black	0-10V dim + / Dali +
White	0-10V dim - / Dali -
Black and White cables has to isolated if not connected	

Cable 3-wired

Brown	Line 230Vac
Blue	Neutral 230Vac
Green/Yellow	Ground

Cable without ground and with signal cables

Brown	Line 230Vac
Blue	Neutral 230Vac
Red	12V signal cable
Purple	0-10V dim + / Dali +
White or Gray	0-10V dim - / Dali -
Red, Purple and White or Gray cables has to isolated if not connected	

Cable with ground and signal cables

Brown	Line 230Vac
Blue	Neutral 230Vac
Green/Yellow	Ground
Red	12V signal cable
Purple	0-10V dim + / Dali +
White or Gray	0-10V dim - / Dali -
Red, Purple and White or Gray cables has to isolated if not connected	